



# LQ 100 - 1 2700K

## General

The LQ 100 - 1 2700K is a highly efficient and versatile LED fixture for architectural applications. Due to the light intensity the fixture in combination with narrow beam reflectors can be perfectly used to illuminate objects in a distance.

## Multiple Protocols

The ON/OFF fixture can be alternatively dimmed via DMX. The electronics of the fixture are prepared for optional Wireless DMX W-DMX or Lumenradio CRMX modules.

## Mechanics

The fixture comes in a compact, rugged, anodised aluminium housing. Its small dimensions and the low weight of only 5,2 Kg are allowing an easy positioning.

## Optics

The available beam angles of the optical system are based on a vast range of own developed custom made reflectors. The calculations for the reflectors were made by optical specialists for this specific fixture range. The usage of a reflector compared to a lens system generally grants a more even light image and colour distribution.

## Production

The development and the production of the fixture and its electronics are completely Made in Germany

## COMMON FEATURES

- Power supply: 240V AC, white 2700K, CRI >90
- System performance: 125W
- Lumen performance per watt: White 151, (total 18.875)
- LED lifetime: >75.000 hours, based on 25°C ambience temperature
- ON/OFF, alternatively dimmable via DMX. Prepared for the optional integration of Wireless DMX (WDMX) or Lumenradio (CRMX) modules
- Cooling via natural convection
- Flicker free
- 16 bit resolution
- All working parameters can be set up and adjusted via IR programmer or magnetic sensor.
- Available beam angles: 5°, 10°, 30°, 50°, 70° and 100°
- IP66 protection
- Transversely waterproof outdoor cable
- Anodised aluminium housing Made in Germany
- Housing colours can be customised

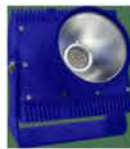
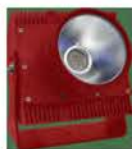

## Accessories

### Ring Louvre

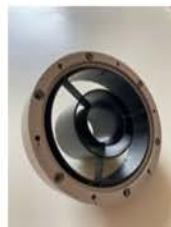

Anti glare protection

### Wallwash Reflector



Ideal solution when the fixture is supposed to be positioned directly in front of the facade



## Photometrics

### 10° Reflector

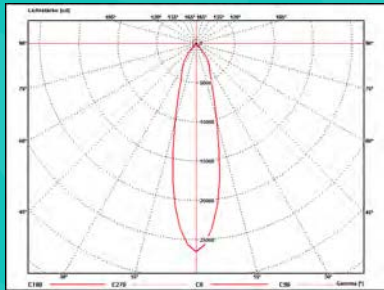

### 30° Reflector

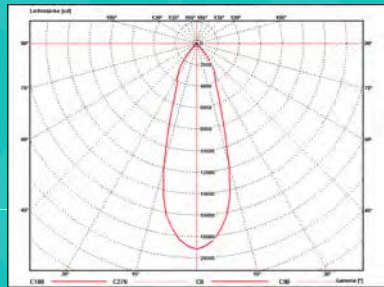

### 50° Reflector

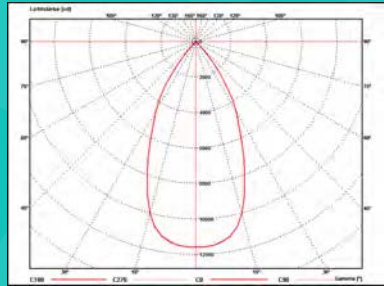

### 70° Reflector

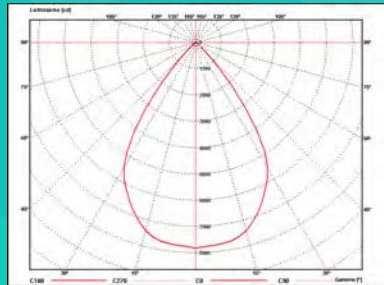

## Mechanics

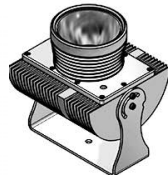
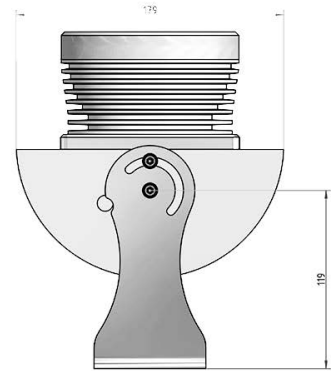
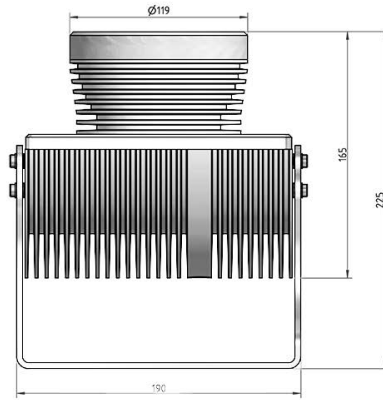

St. Laurentius Kirche,  
Markranstädt,  
Germany

Roller coaster, Tripsdrill, Germany

